

STEEL OIL-TIGHT HOLE SEALS

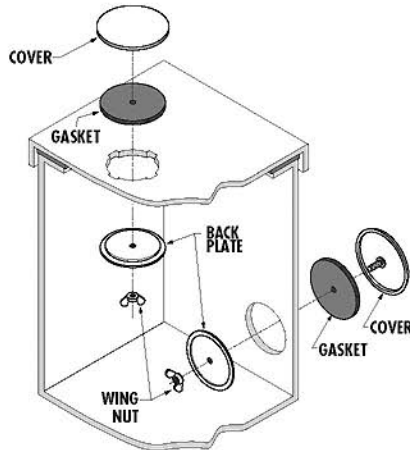

Description	Max. Hole Diameter	Hole Seal Diameter	Catalog Number
Miniature Oil-Tight PB Holes	0.88"	1.22"	PBMHS
Standard Oil-Tight PB Holes	1.25"	1.75"	PBHS
1/2" Conduit Holes	0.88"	1.38"	50HS
3/4" Conduit Holes	1.06"	1.56"	75HS
1" Conduit Holes	1.38"	1.88"	100HS
1-1/4" Conduit Holes	1.69"	2.19"	125HS
1-1/2" Conduit Holes	2.00"	2.50"	150HS
2" Conduit Holes	2.50"	3.00"	200HS
2-1/2" Conduit Holes	3.00"	3.50"	250HS
3" Conduit Holes	3.62"	4.12"	300HS
3-1/2" Conduit Holes	4.12"	4.62"	350HS
4" Conduit Holes	4.62"	5.12"	400HS

STAINLESS STEEL OIL-TIGHT HOLE SEALS

Description	Max. Hole Diameter	Hole Seal Diameter	Catalog Number
Miniature Oil-Tight PB Holes	0.88"	1.22"	SPBMHS
Standard Oil-Tight PB Holes	1.25"	1.75"	SPBHS
1/2" Conduit Holes	0.88"	1.38"	S50HS
3/4" Conduit Holes	1.06"	1.56"	S75HS
1" Conduit Holes	1.38"	1.88"	S100HS
1-1/4" Conduit Holes	1.69"	2.19"	S125HS
1-1/2" Conduit Holes	2.00"	2.50"	S150HS
2" Conduit Holes	2.50"	3.00"	S200HS
2-1/2" Conduit Holes	3.00"	3.50"	S250HS
3" Conduit Holes	3.62"	4.12"	S300HS
3-1/2" Conduit Holes	4.12"	4.62"	S350HS

Application

E-Box Hole Seals are used to seal unused push button holes, conduit and knockout holes and other openings of irregular shapes and size against dust, dirt, water and oil. They will cover holes ranging in sizes from .19" through 4.00", and can be used on enclosures having a wall thickness up to .31".

Design

An Oil Tight Hole Seal has a cover with a 1/16" flange formed around the perimeter and a #10 x 5/8 stud welded in the center. A gasket is placed over the stud and these two parts are usually positioned on the outside of the enclosure. A backplate and wing nut are fastened to the Seal from the inside of the enclosure. As the wing nut is tightened, the cover compresses the gasket and seals the hole.

Materials

#10-21 x 5/8 studs are zinc plated for steel Seals and stainless steel for stainless steel Seals. Wing nuts for stainless steel covers are 18-8 stainless steel. Wing nuts for steel covers are A-36 steel. All gaskets are oil-resistant closed cell neoprene.

Finish

Steel hole seal covers are painted ASA-61 gray over a zinc coated surface. Backplates are unpainted galvanized steel. Stainless steel hole seal covers are polished to a #3 finish and backplates are T304 SS with #2B finish. Steel wing nuts are zinc plated with a yellow dichromate rinse.