

FRONT VIEW WITH LID REMOVED

(4) EACH #10-32 BRASS INSERTS
AND STAINLESS STEEL
CAPTIVE COVER SCREWS

NON-METALLIC TYPE 4X SCREW COVER BOXES

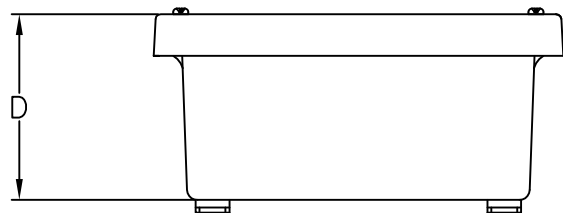

(4) STAINLESS STEEL
MOUNTING FEET

CONSTRUCTION:

- STRONG MOLDED FIBERGLASS REINFORCED POLYESTER CONSTRUCTION WITH MATCHING COVER.
- CAPTIVE STAINLESS STEEL COVER SCREWS.
- GASKET MATERIAL MADE OF CLOSED-CELL NEOPRENE CORD.
- STAINLESS STEEL WALL MOUNTING HARDWARE WITH 10-32 STAINLESS STEEL SCREWS INCLUDED.
- 10-32 THREADED INSERTS ARE INSTALLED FOR OPTIONAL BACK PANEL OR TERMINAL KITS.
- FIBERGLASS MATERIAL IS EASILY PUNCHED, DRILLED, OR SAWED.
- UV STABILIZED MATERIAL FOR OUTDOOR USE.

CATALOG#	-H-	-W-	-D-
NJSC664	6.10	6.10	4.18
NJSC864	8.00	6.13	4.13
NJSC1086	10.14	8.26	6.13
NJSC12106	12.14	10.26	6.13
NJSC14126	14.13	12.25	6.13

APPROVAL:



E-BOX
101 Air Park Industrial Road
Alabaster, Alabama 35007
Phone: (205)663-9189
Fax: (205)663-9587

