

CATALOG#: SPN4X

UL LISTED

CANADIAN UL LISTED

NOTE: MAXIMUM SPACING BETWEEN CLAMPS ARE 15.00 INCHES.

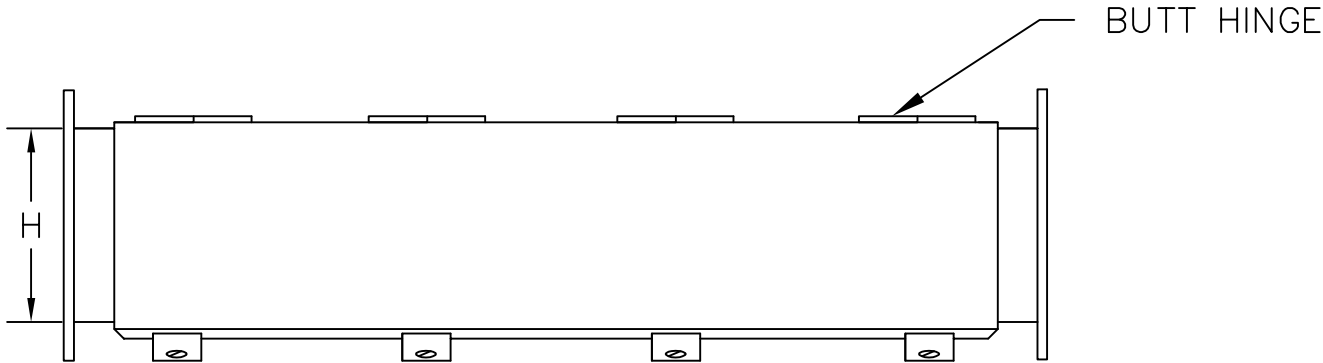

STAINLESS STEEL TYPE 4X PULL THROUGH WIREWAY

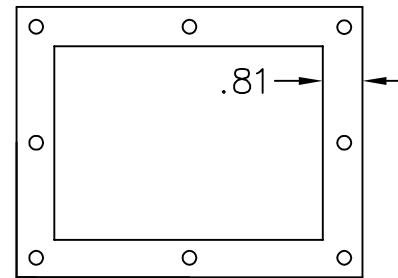
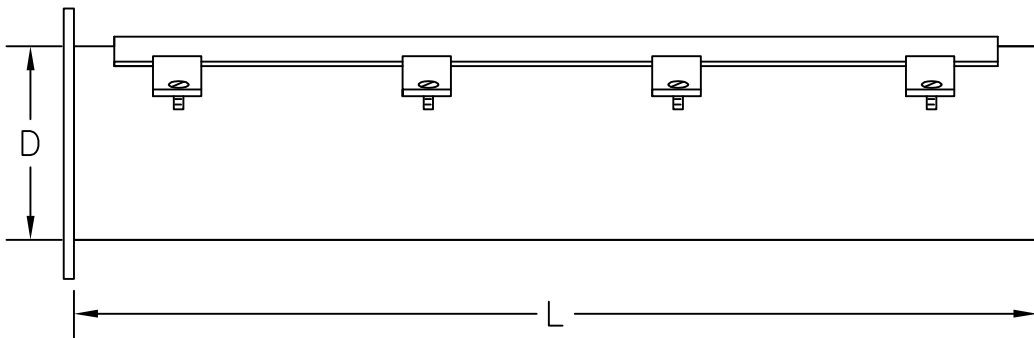

CONSTRUCTION:

- CODE GAUGE TYPE 304 STAINLESS STEEL.
- 12 GAUGE TYPE 304 STAINLESS STEEL END FLANGES.
- SEAMS CONTINUOUSLY WELDED AND GROUND SMOOTH.
- STAINLESS STEEL BUTT HINGE.
- SCREW CLAMPS ARE QUICK AND EASY TO OPERATE.
- OIL RESISTANT GASKET.
- GASKET POSITIONED BETWEEN FLANGES WHEN SECTIONS AND FITTINGS ARE BOLTED TOGETHER.

FINISH:

- WIREWAY ARE UN-PAINTED AND HAVE A SMOOTH BRUSH FINISH.

-H-	-D-	-L-

APPROVAL: _____



E-BOX
 101 Air Park Industrial Road
 Alabaster, Alabama 35007
 Phone: (205)663-9189
 Fax: (205)663-9587

