

UL LISTED

CANADIAN UL LISTED

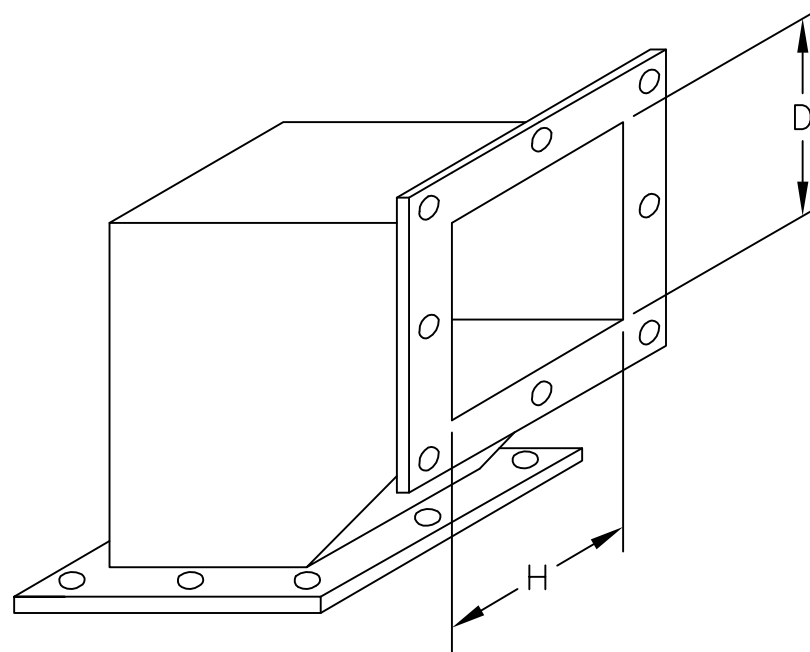

90 ELBOW

TYPE 12 PULL THRU FITTINGS

CONSTRUCTION:  
-CODE GAUGE PAINT GRIP  
GALVANIZED STEEL.  
-12 GAUGE STEEL END  
FLANGES.  
-SEAMS CONTINUOUSLY  
WELDED AND GROUND  
SMOOTH.  
-OIL RESISTANT GASKET.  
-GASKET POSITIONED  
BETWEEN FLANGES WHEN  
SECTIONS AND FITTINGS  
ARE BOLTED TOGETHER.

FINISH:  
-ANSI 61 GRAY POLYESTER  
POWDER COATING INSIDE AND  
OUT.

| -H- | -D- |
|-----|-----|
| 4   | 4   |
| 6   | 6   |
| 8   | 8   |

APPROVAL: \_\_\_\_\_



E-BOX

101 Air Park Industrial Road  
Alabaster, Alabama 35007

Phone: (205)663-9189

Fax: (205)663-9587

