

UL LISTED

CANADIAN UL LISTED

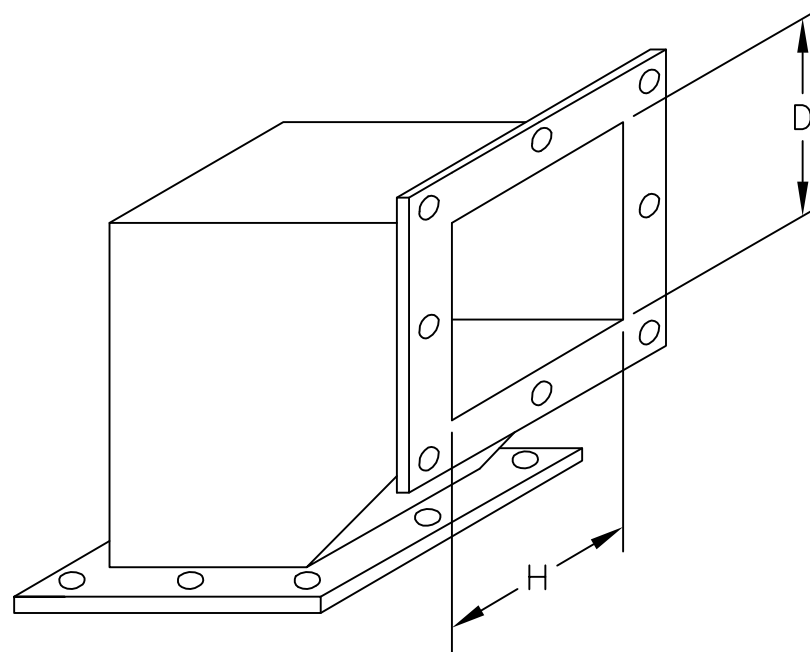

90 ELBOW

TYPE 4X PULL THRU FITTINGS

CONSTRUCTION:
-CODE GAUGE TYPE 304
STAINLESS STEEL.
-12 GAUGE TYPE 304 STAINLESS
END FLANGES.
-SEAMS CONTINUOUSLY
WELDED AND GROUND
SMOOTH.
-OIL RESISTANT GASKET.
-GASKET POSITIONED
BETWEEN FLANGES WHEN
SECTIONS AND FITTINGS
ARE BOLTED TOGETHER.

FINISH:
-NUMBER 3 SMOOTH BRUSH
FINISH.

-H-	-D-
4	4
6	6

APPROVAL: _____



E-BOX

101 Air Park Industrial Road
Alabaster, Alabama 35007

Phone: (205)663-9189

Fax: (205)663-9587

